

Need 2 Know #12

Locks & Codes	Page 2 – back of entry door, below Welcome
Front Hall Entrance	Page 3 – back of closet door
Kitchen	Page 4 – Fridge, below Welcome
Patio	Page 5 – inside main patio door
Living Room	Page 6 – left of TV
Bathroom on Main Floor	Page 7 – back of door
Bathroom on 2 nd Floor	Page 8 – back of main door
Master Bedroom	Page 9 – back of door
Guest Bedroom	Page 10 – back of door
Kids Bedroom	Page 11 – back of door

Notes

Noise – We have many residents & guests, please keep noise level down at all times.

Parking – Only park in your spot identified by the condo number. Unmarked spaces are available on a first come first served basis.

Beach Area – Return all lounge chairs to their storage area under the stairs. Do not take chairs into the water as this promotes premature rusting.

Garbage – Garbage from the unit needs to be removed and placed in the dumpster at the front of the complex, just south of the entrance from the road.

Need 2 Know – Locks & Codes (all access codes will be given upon request)

- One key operates both locks on the front door. Note: you must unlock the top deadbolt first and then the bottom lock.

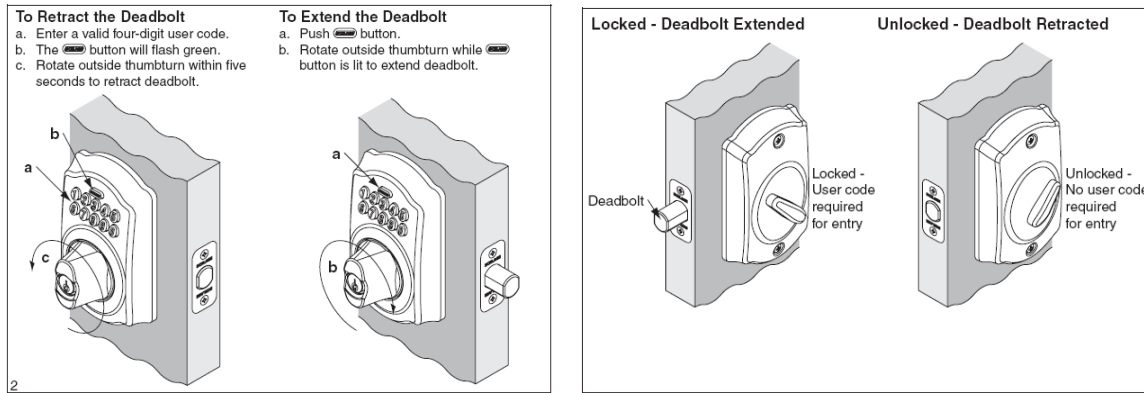

Key Override

NOTE: Key will both extend and retract deadbolt.

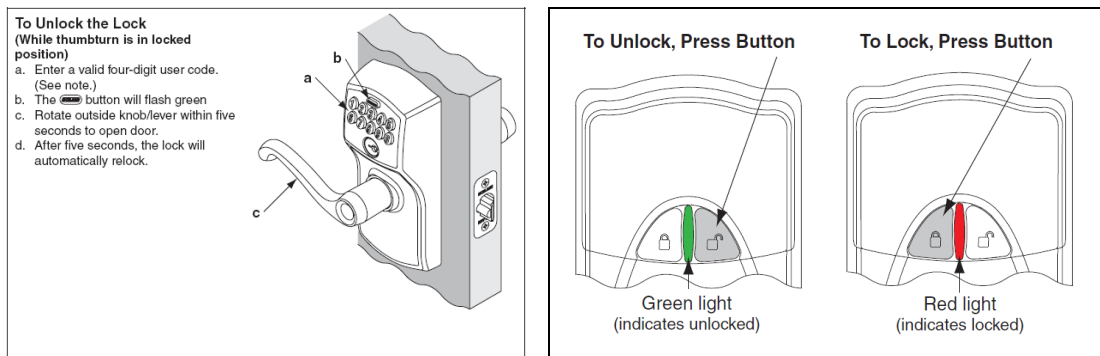
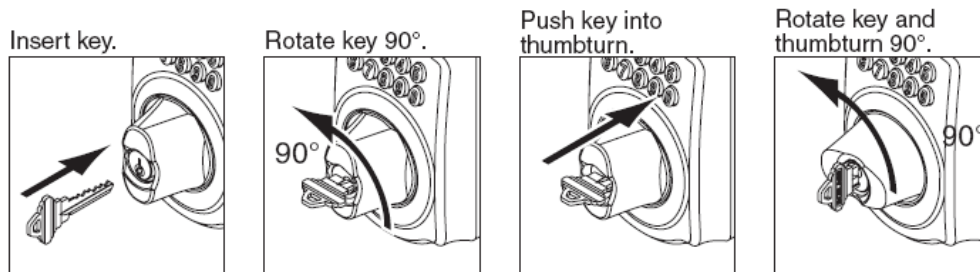

Key Override

NOTE: Key does not retract latch.

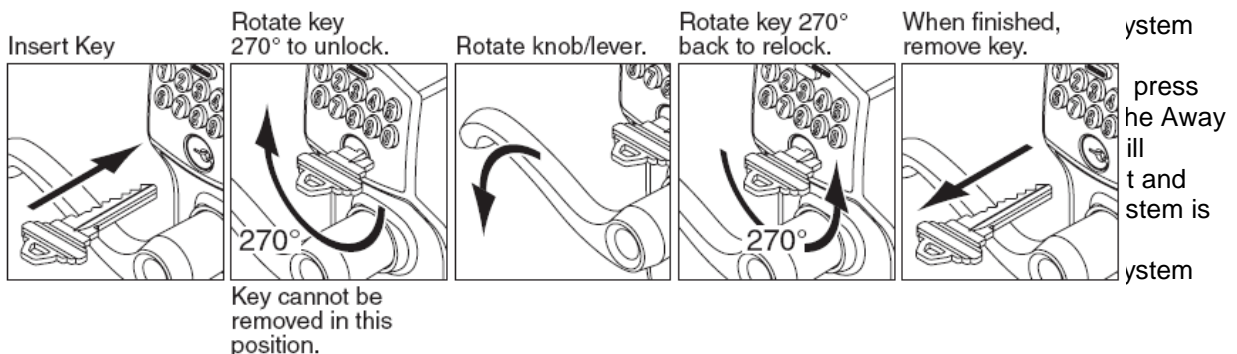

Need 2 Know – Front Hall Entrance

- **To Arm Security System:** Press the Away button on the security screen and enter your four digit code. The keypad will immediately start to beep indicating your 30 second count down to depart the unit and lock the front door. The LED light on the keypad will turn from green to red indicating that the system is armed.
- **To Disarm Security System:** When re-entering the unit if the alarm has been armed, the keypad will start to emit a constant tone reminding you to disarm the system. Press the Off button and enter your four digit code. The LED light will turn from red to green indicating that you have successfully disarmed the system. You have 30 seconds to disarm the system upon entering the unit.
- To enter tennis court, use the key on one of the key sets hanging in the front closet. Lights are located on the pole to the North outside of the court.

Inventory

Eureka Bagless Vacuum
Sun Umbrellas x 2
Tennis Rackets x 4
Broom & Dust Pan
Mop & Bucket
Instant On-Demand Hot Water System

Need 2 Know – Kitchen

- Use Cerama Bryte, a dry paper towel and rub hard for stove top
- Water from fridge is filtered via under counter system (not the fridge unit)
- All cleaning supplies located under sink
- Dishwashing soap is located in counter mounted dispenser to right of tap
- Music System: There is an under-counter CD/Stereo system located beside the fridge. It is equipped with a built in CD player, and an FM radio.

Inventory

Electric Kettle
Coffee Grinder
Blender
4 Slice Toaster
Coffee Maker
Frigidare Electric Range
Kenmore Refrigerator
Kenmore Dishwasher
Whirlpool Microwave
Table & 4 chairs & 2 stools
Pot Set
Cutlery 8 settings
Patio Glassware
Dinnerware settings
Can Opener & Cork Screw
Under Counter Radio

Need 2 Know – Patio

- Clothes racks are mounted on the wall. To use, flip up the silver cover and extend the rods by pulling away from the wall. To close, flip up silver cover, and push rods towards wall.
- BBQ – ensure propane tank is turned on. If it needs to be refilled, please exchange it for a full tank across the street at the Texaco. The condo owners will reimburse you for the cost of the propane (est C\$30). To remove tank, disconnect and remove from the back of the BBQ.

Note: A/C will turn off if doors left open for longer than 5 minutes.

Inventory

Patio Furnishings (4 chairs & round table)
BBQ

Need 2 Know – Living Room

- There are two remote controls for the TV/Home theatre system in the living room, both labelled; one for the Weststar Digital Cable box, and one for the Panasonic TV and DVD stereo System.
- To Watch TV: Turn on the digital cable box with the cable box remote. A green indicator on the cable box will light showing that it is on. Turn on the TV by pressing the smaller TV power button located in the middle top of the Panasonic remote (inside the TV control outline). A red indicator on the TV will light in the bottom left corner. Ensure that the TV is on the correct input by pressing the TV/Video button (beside the TV power button) and cycle through to the “Cable” Input. Channels and electronic program guides can be controlled with the Digital Cable remote. Volume may be controlled by using the volume buttons on the top right hand side of the Panasonic remote that controls the volume of the TV speakers. Also note: The digital cable box remote also has volume commands. This volume has been set to the mid way point and should not be adjusted further. If there does not seem to be sound, you should check this volume to ensure it has not been turned all the way down.
- To Watch a DVD: On the Panasonic TV/Stereo remote, press the “One Touch Play” button located in the centre of the remote above the circular cursor pad. This will turn on the stereo, DVD, and set the correct inputs. Select the appropriate disc number for the DVD you would like to watch.
- Turning Off System: Press the smaller TV power button and both the TV and DVD/stereo system will turn off. Please ensure the TV and Stereo are turned off after
- DVD movies located under TV.
- Note: The Home Theatre system must be off for sound to work from the satellite box.

Inventory

Panasonic 42" HDTV 42PX60 w/Remote
Panasonic DVD Home Theatre
Satellite Receiver w/Remote
Xbox 360 & controllers
Panasonic Cordless 2 Line Phone
Leather Sectional
Wicker Chairs
Glass Tops

Need 2 Know – Bathroom on Main Floor

- Electronic Timers for Exhaust Fan & Shower Lights
- Note: On the dryer, set it to 'less' dry – it gets very hot

Inventory

Washer and stacking Dryer

<u>Towels</u>	Out	Stored
Face	2	2
Hand	1	1
Body	2	0
Mat	1	1
Beach	6	

Need 2 Know – Bathroom on 2nd Floor

- Electronic Timers for Exhaust Fan

Inventory
Hair Dryer

<u>Towels</u>	Out	Stored
Face	4	2
Hand	1	1
Body	4	0
Mat	1	1

Need 2 Know – Master Bedroom

- All linens for the king bed are located in the closet on the top shelf on the left hand side.
- Asus computer is mounted on the back of the LCD. To power on, press large round button found on the right hand side of the rear of the LCD on the PC

Inventory

King Size Pillows x 2
Complete Set Of King Sheets x 2
Body Towels x 2
Extra Pillows x 2
Extra light cotton blanket
Anti-Allergy pillow and mattress covers
Lazboy Duvet
Panasonic Cordless 2 Line Phone
Computer w/19" LCD & Internet
Samsung Laser Printer
Alarm Clock

Need 2 Know – Guest Bedroom

- All linens for the queen bed are located in the closet.

Inventory

Queen Size pillows x 2
Complete Set Of Queen Sheets x 2
Body Towels x 2
Extra light cotton blanket
Anti-Allergy pillow and mattress covers
Lazboy Duvet
Alarm Clock
Ironing Board & Iron (in closet)

Need 2 Know – Kids Bedroom

- CAUTION – when on top bunk, be aware of fan.
- All linens for the beds are located in the closet on the top shelf on the left hand side.
- Crib is located in the closet – note: MUST BE ASSEMBLED
 - No Bedding For Crib is Provided – Please Bring Your Own Bedding

Inventory

Standard size pillows x 2
Complete Set Of Double Sheets x 2
Complete Set Of Single Sheets x 2
Extra light cotton blankets x 2
Bunk Bed (Single & Single)
Dresser
Anti-Allergy pillow and mattress covers
Lazboy Duvets
Alarm Clock
Crib
Aerobed Twin with pump
Fisher-Price Space Saver Highchair (stored in closet)